

- Face mounted adjustable pattern deflectors
- Hinged / removable face allows for easy access to damper
- Optional square damper is shipped loose and field mounted
- Model **PP** is all steel construction
- Model **APP** is steel backpan with aluminum face
- Standard finish is white

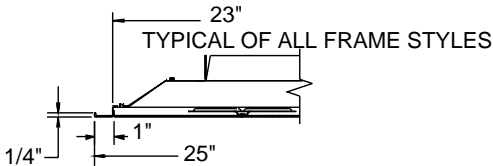

Frame SF (Surface Mount)
*minimum ceiling opening 23-1/4"

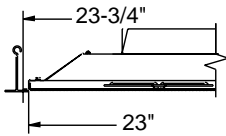

Frame LT (Lay-in T-Bar)

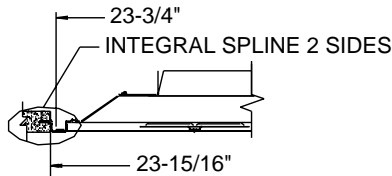

Frame PL (Spline)

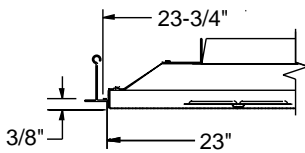

Frame TG (Tegular)**

**NOTE: Frame TG not available for Model APP

Frame Detail:
24 x 24 Module Size

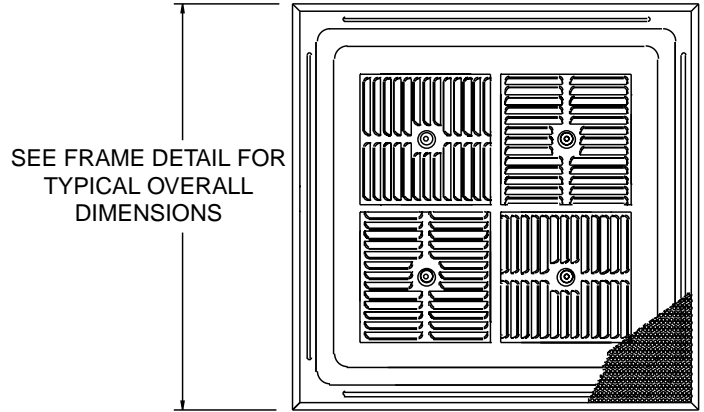

PP **APP**

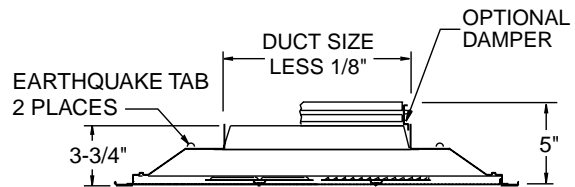

Side View/Damper Detail, SF Frame

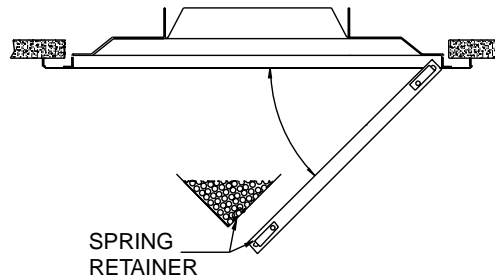

Face Hinge Detail

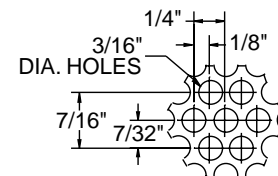

Perforated Pattern Detail
(51% free area)

Dimensions are in inches. Product information subject to change without notice.

PROJECT:	SUBMITTED BY:	DATE: 7/02/01	SD - 1775
ARCHITECT:		PP, APP Square Neck Perforated Supply Face Mounted Deflectors 24 x 24 Module Size	
ENGINEER:			
CONTRACTOR:			
LOCATION:			